

## The Water Gardens W2

£598,000 leasehold

CLUTTONS



**A newly renovated, bright, dual aspect, spacious one bedroom apartment, arranged on the fourth floor (with lift) in a portered block with a long lease.**

The property offers a spacious living area, large bedroom and benefits from large windows resulting in a flood of natural light.

The Water Gardens is located just to the north of Hyde Park a few blocks from Marble Arch and close to Paddington Main Line Station and the Heathrow Express/ Crossrail, District, Circle, Hammersmith and City tube lines are all available at Edgware Road Station together with the Bakerloo line also located on Edgware Road and the Central Line at Lancaster Gate. A variety of buses and super markets such as Waitrose and Tesco are moments away on Edgware Road.

Service Charge: £4,856 pa (approx.)  
Council Tax Band: E  
Lease Length = 152 years remaining

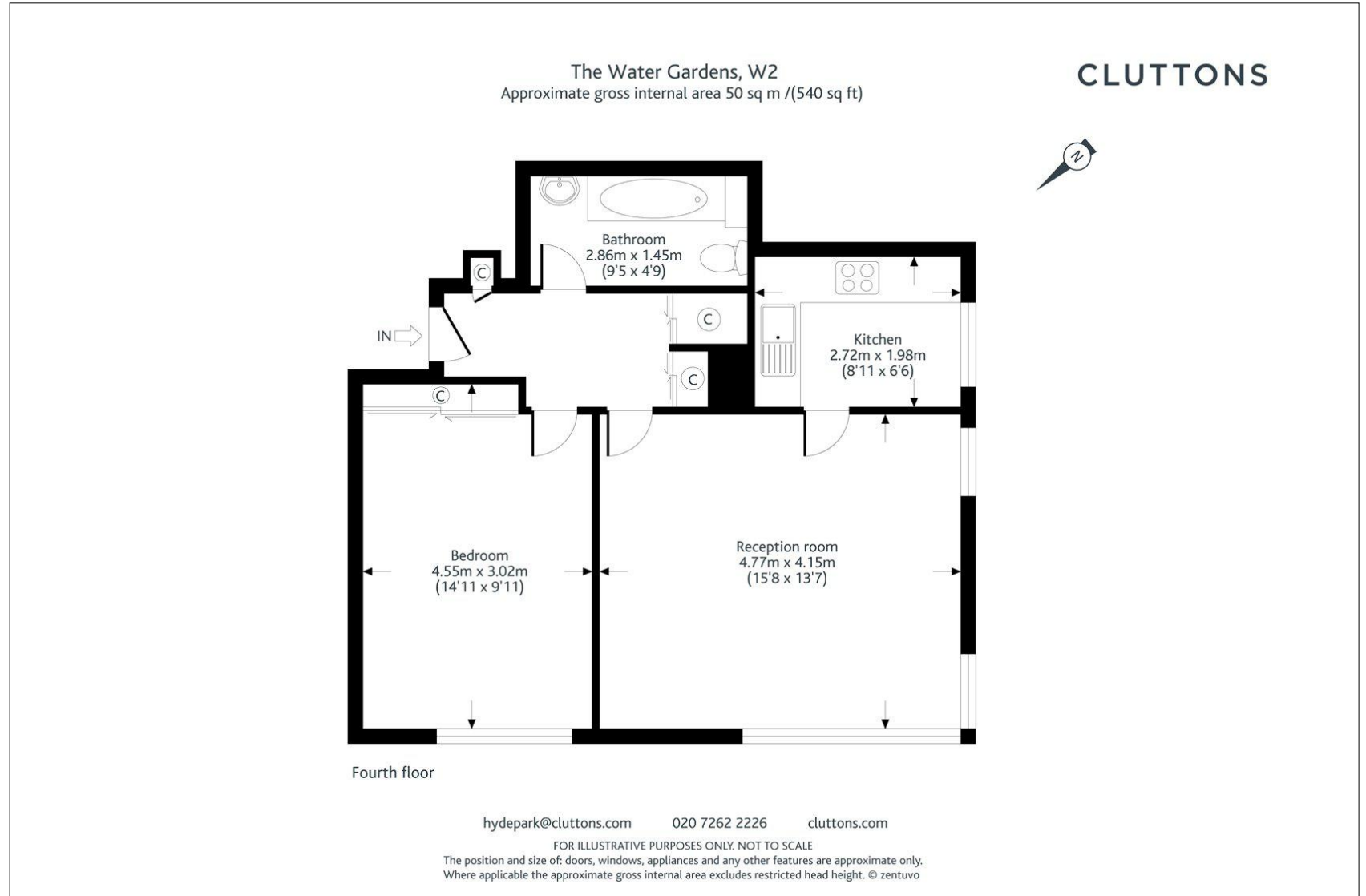

Approximate gross internal area:  
540 sq ft (50.2 sq m)  
EPC rating: D | Ref: ALB170085





---

For further details contact

Verity Chick  
020 7262 2226  
verity.chick@cluttons.com

This is made from FSC certified paper, part of our commitment to use more sustainable materials. FSC, protecting the world's forests for the future. Please recycle.



**Cluttons**  
23 Albion Street  
London  
W2 2AS  
**cluttons.com**

Cluttons LLP for itself and as agent for the vendor or lessor (as appropriate) gives notice that: 1. These particulars are only a general outline for the guidance of intending purchasers or lessees and do not constitute in whole or in part an offer or a Contract. 2. Reasonable endeavours have been made to ensure that the information given in these particulars is materially correct but any intending purchaser or lessee should satisfy themselves by inspection, searches, enquiries and survey as to the correctness of each statement. 3. All statements in these particulars are made without responsibility on the part of Cluttons LLP or the vendor or lessor. 4. No statement in these particulars is to be relied upon as a statement or representation of fact. 5. Neither Cluttons LLP nor anyone in its employment or acting on its behalf has authority to make any representation or warranty in relation to this property. 6. Nothing in these particulars shall be deemed to be a statement that the property is in good repair or condition or otherwise nor that any services or facilities are in good working order. 7. Photographs may show only certain parts and aspects of the property at the time when the photographs were taken and you should rely upon actual inspection. 8. No assumption should be made in respects of parts of the property not shown in photographs. 9. Any areas, measurements or distances are only approximate. 10. Any reference to alterations or use is not intended to be a statement that any necessary planning, building regulation, listed building or any other consent has been obtained. 11. Amounts quoted are exclusive of VAT if applicable.