



Two Bedroom Apartment Alencon Link, Basingstoke, RG21 7TW

Offers in excess of: £190,000

- Two Bedrooms
- Eighth Floor Apartment
- Ideal Town Centre Position
- Underground Parking
- En Suite and Family Bathroom
- Long Lease
- No Onward Chain
- EPC : C (77)



Description

Situated in the popular development Crown Heights in the heart of Basingstoke this property has easy access to Festival Place Shopping Centre, bus and train station as well as links to the A339 and M3.

The spacious two bedroom apartment is one of the larger designs, located on the eighth floor it offers an en suite and family bathroom, underground parking, long lease, modern kitchen and a 17ft living/dining room. The property is offered to the market with no onward chain complications to cash buyers only and potential of an ongoing tenant in situ.

Outside

Externally the property offers an underground residents parking space.

N.B: Please note this floorplan is for illustrative purposes only and the apartment is a flipped mirror image of the floorplan on the brochure.

Floorplan

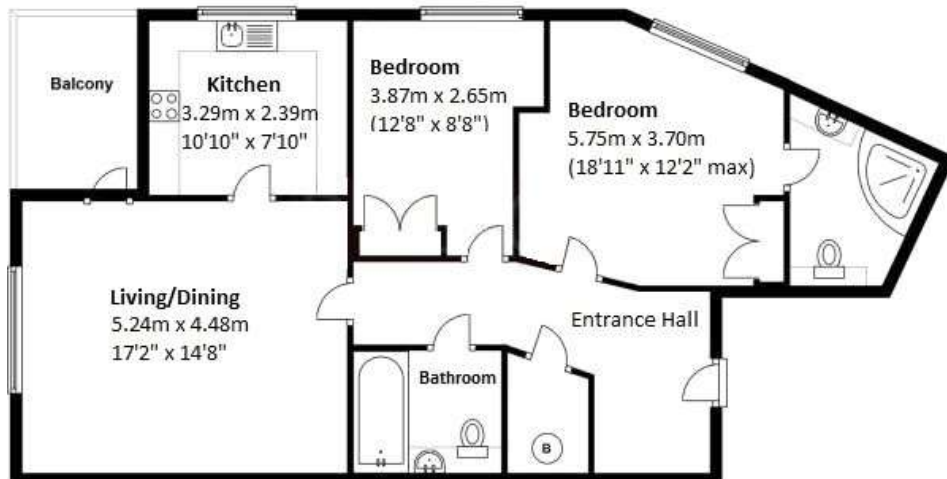

To arrange a viewing please contact:

Tel: 01256 880001

Email: basingstoke@bridges.co.uk

Important Notice - These particulars are set out as a general outline only for the guidance of intended purchasers and do not form part of any offer or contract and must not be relied upon as statements or representations of fact. Purchasers must satisfy themselves by inspection or otherwise as to their correctness.