



## Three Bedroom Semi-Detached House

**Wood Lane, Farnborough, Hampshire, GU14 0AJ**

Asking Price: £475,000

- Three Double Bedrooms
- Potential to Extend (STPP)
- Corner Plot
- Close to Local Schools
- Driveway Parking
- Fully Refitted Kitchen/Diner
- Easy Access to Town Centre
- EPC : TBC



## Description

This three double bedroom extended semi-detached home is offered to the market with huge scope to extend further, subject to planning permission. Within easy reach of both Farnborough town centre and Farnborough Main station this property comprises an entrance hall leading to modern open plan kitchen and dining area, with built in white goods and bi-folding doors leading to garden, there is also a further reception room with high vaulted ceiling with sky lights, half return staircase to first floor, with three double bedrooms, a modern bathroom suite, downstairs utility room and separate cloakroom. Further benefits include double glazing throughout, gas central heating and a well sized garden plot. Viewings are highly recommended!

## Outside

Private enclosed rear garden, with side access to the front. The property is on a corner plot, with ample parking and potential to extend (STPP).

## Floorplan

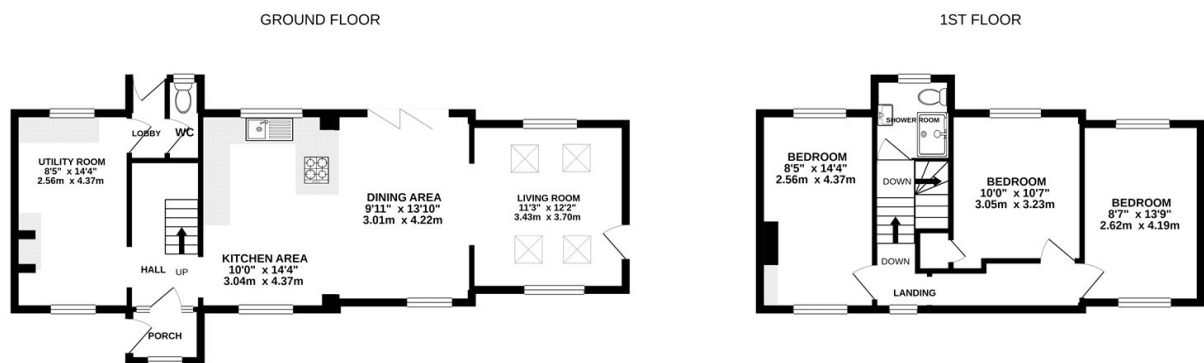

Whilst every attempt has been made to ensure the accuracy of the floorplan contained here, measurements of doors, windows, rooms and any other items are approximate and no responsibility is taken for any error, omission or mis-statement. This plan is for illustrative purposes only and should be used as such by any prospective purchaser. The services, systems and appliances shown have not been tested and no guarantee as to their operability or efficiency can be given.  
Made with Metropix ©2021



**To arrange a viewing please contact:**

Tel: 01252 361550

Email: [info@bridges.co.uk](mailto:info@bridges.co.uk)

**Important Notice - These particulars are set out as a general outline only for the guidance of intended purchasers and do not form part of any offer or contract and must not be relied upon as statements or representations of fact. Purchasers must satisfy themselves by inspection or otherwise as to their correctness.**