



Two Bedroom Mobile Home

Martins Park, Sandy Lane, Farnborough, GU14 9JZ

Guide Price: £75,000

- Two Double Bedrooms
- Park Home
- Vacant Possession
- Good Size Sitting Room
- Off Road Parking
- Fitted Kitchen
- Garden to Front and Side
- Age Restricted to 45 Years of Age



Description

This two bedroom single unit park home in the popular location of Martins Park, Sandy Lane. Internally the property would benefit from some modernising. The property is age restricted to those of 45 years of age and is being sold as a vacant possession.

Outside

Small garden to the front and side of the property.

Floorplan

GROUND FLOOR
1240 sq.ft. (115.2 sq.m.) approx.

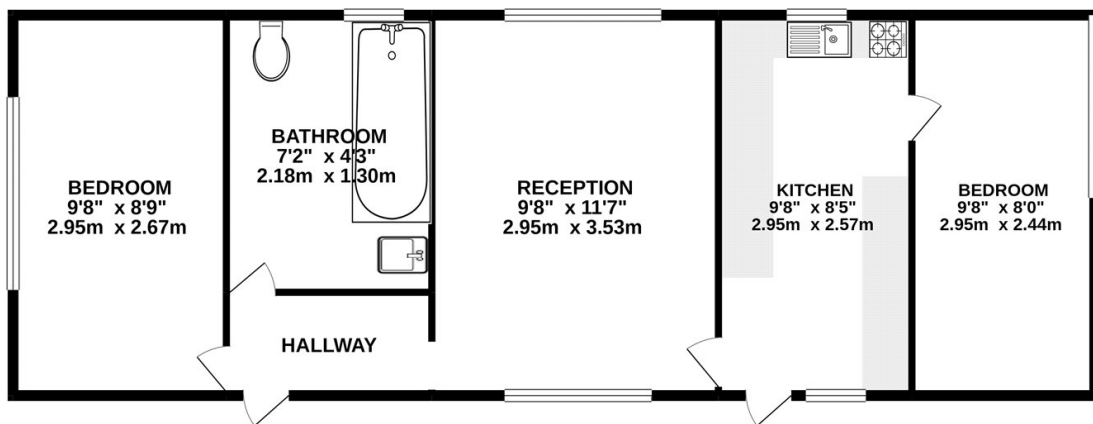

TOTAL FLOOR AREA : 1240 sq.ft. (115.2 sq.m.) approx.

Whilst every attempt has been made to ensure the accuracy of the floorplan contained here, measurements of doors, windows, rooms and any other items are approximate and no responsibility is taken for any error, omission or mis-statement. This plan is for illustrative purposes only and should be used as such by any prospective purchaser. The services, systems and appliances shown have not been tested and no guarantee as to their operability or efficiency can be given.
Made with Metropix ©2021



To arrange a viewing please contact:

Tel: 01252 361550

Email: info@bridges.co.uk

Important Notice - These particulars are set out as a general outline only for the guidance of intended purchasers and do not form part of any offer or contract and must not be relied upon as statements or representations of fact. Purchasers must satisfy themselves by inspection or otherwise as to their correctness.