

central
1992

0208 520 0033
enquiries@central-
estates.co.uk

179 Hoe Street
London
E17 3AP

central-estates.co.uk

Temple Close

E11 1JN

£325,000

Freehold House





- 0.66 miles**
 1
- 15ft approx.**
 1
- Allocated Parking Space**
 1

Temple Close
E11 1JN
£325,000
Freehold House

Floor Plans

Temple Close, E11



Approximate Gross Internal Area 704 sq. ft - 65.4 sq. m.

Temple Close is situated just a 10 minute walk to LEYTONSTONE STATION, and will get you directly to Liverpool Street in fourteen minutes, or Tottenham Court Road in twenty three, via the CENTRAL LINE which runs 24 hours at the weekends. EPPING FOREST is an 8 minute walk where you can hire out boats on Hollow Pond and enjoy nice walks.

This is a FANTASTIC semi-detached HOME with a charming COTTAGE FEEL, being offered with NO ONWARD CHAIN. With a SPIRAL STAIRCASE, feature fireplace and wood flooring internal viewing is recommended. Comprising a lounge, fitted kitchen, double bedroom, fitted bathroom and a wonderfully spacious loft space. There is also a lovely GARDEN to the front of the property and an ALLOCATED PARKING space.

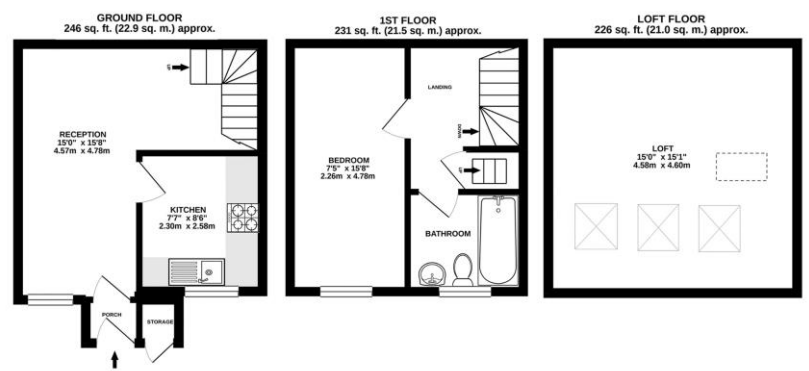

Total Floor Area 704 sq. ft. - 65.4 sq. m. Approx.

Features

- Approx. 704 sq. ft.
- One Bedroom
- Freehold House
- Charming Cottage Feel
- No Onward Chain
- Spiral Staircase
- Fantastic Location

For Illustration Purposes Only - Not To Scale.
lpaplus.com

EPC Ratings

Energy Efficiency Rating	69
Environmental Impact (Co ₂) Rating	71