

**The Quadrangle W2**  
£1,450,000 leasehold

**CLUTTONS**



A bright and spacious two bedroom apartment located on the second floor within a gated and portered development moments from Hyde Park.

Nestled within a secure development, this spacious property includes a double reception, two large double bedrooms, a balcony overlooking the quiet communal gardens and a long lease.

The property is located moments from Hyde Park, Marble Arch Station (Central Line) and Paddington Station (Bakerloo Line, Circle Line, District Line and Hammersmith & City Line).

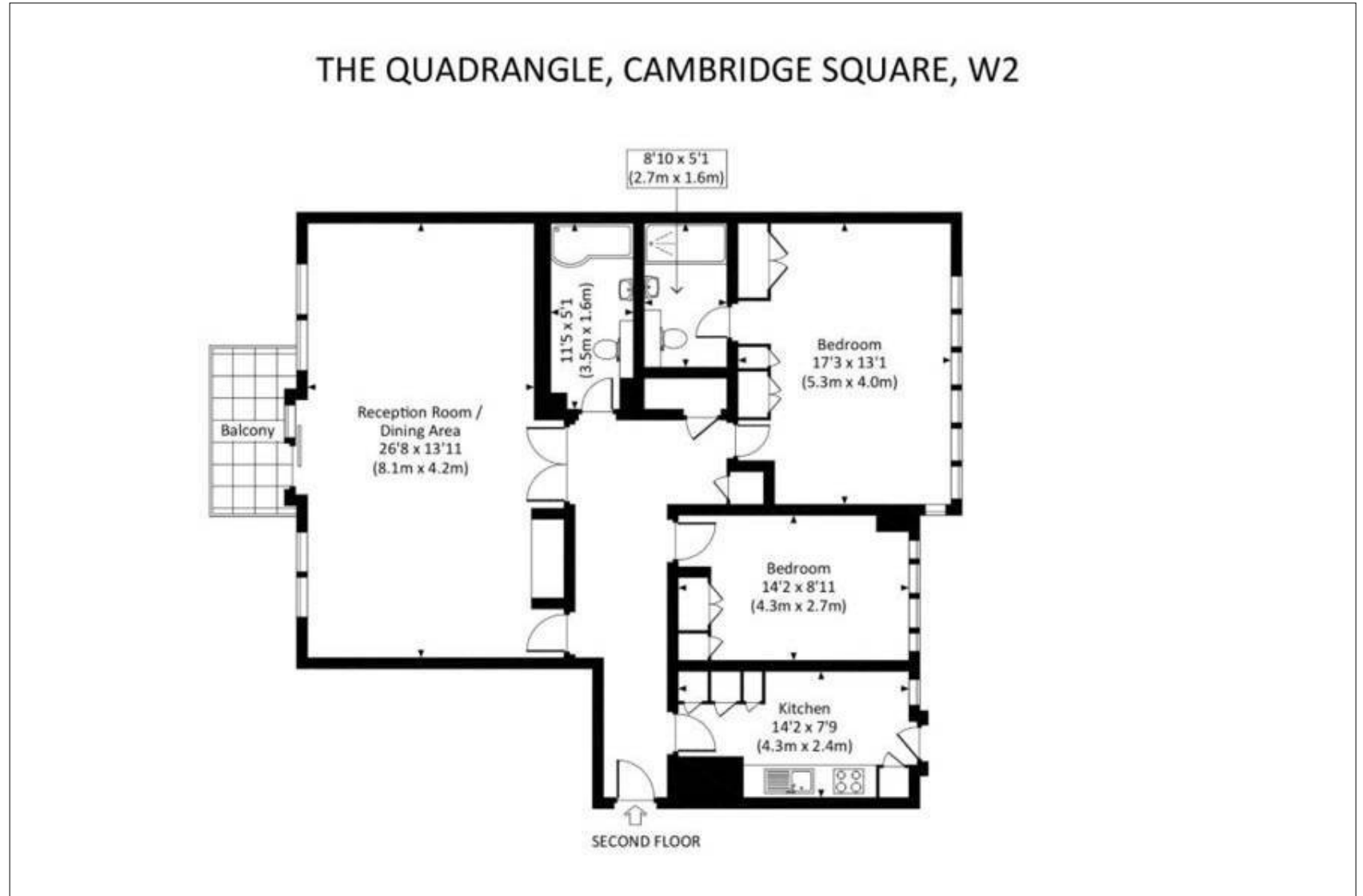

Approximate gross internal area:  
1,196 sq ft (111.1 sq m)  
EPC rating: C | Ref: ALB220063



For further details contact

Veriy Chick  
020 7262 2226  
verity.chick@cluttons.com

This is made from FSC certified paper, part of our commitment to use more sustainable materials. FSC, protecting the world's forests for the future. Please recycle.



**Cluttons**  
23 Albion Street  
London  
W2 2AS  
[cluttons.com](http://cluttons.com)

Cluttons LLP for itself and as agent for the vendor or lessor (as appropriate) gives notice that: 1. These particulars are only a general outline for the guidance of intending purchasers or lessees and do not constitute in whole or in part an offer or a Contract. 2. Reasonable endeavours have been made to ensure that the information given in these particulars is materially correct but any intending purchaser or lessee should satisfy themselves by inspection, searches, enquiries and survey as to the correctness of each statement. 3. All statements in these particulars are made without responsibility on the part of Cluttons LLP or the vendor or lessor. 4. No statement in these particulars is to be relied upon as a statement or representation of fact. 5. Neither Cluttons LLP nor anyone in its employment or acting on its behalf has authority to make any representation or warranty in relation to this property. 6. Nothing in these particulars shall be deemed to be a statement that the property is in good repair or condition or otherwise nor that any services or facilities are in good working order. 7. Photographs may show only certain parts and aspects of the property at the time when the photographs were taken and you should rely upon actual inspection. 8. No assumption should be made in respects of parts of the property not shown in photographs. 9. Any areas, measurements or distances are only approximate. 10. Any reference to alterations or use is not intended to be a statement that any necessary planning, building regulation, listed building or any other consent has been obtained. 11. Amounts quoted are exclusive of VAT if applicable.