

Meridian Court SE16
£625,000 leasehold

CLUTTONS



A two bedroom apartment with private south facing balcony, located close to the river front and the Jubilee Line.

The property consists of an open plan reception room with fully integrated kitchen, and access to a private balcony. The floor to ceiling windows allow an abundance of natural light to flood the apartment. Both bedrooms are generous doubles, the principal with Juliette balcony. The modern bathroom is off the entrance hallway.

Meridian Court is a respected modern development by Berkeley Homes with daytime porter, lift access and a great location close to all the bars, restaurants and shops within Shad Thames. Bermondsey station (Jubilee line), London Bridge station (Northern line, Jubilee line and National Rail services) and are both within easy reach.

- Lease: 999 years from 1 January 2003
- Service charge: circa £880.18 per quarter (circa £3,520.72 per annum)
- Ground rent: £75 half yearly (£150 per annum)
- Council tax: Band C

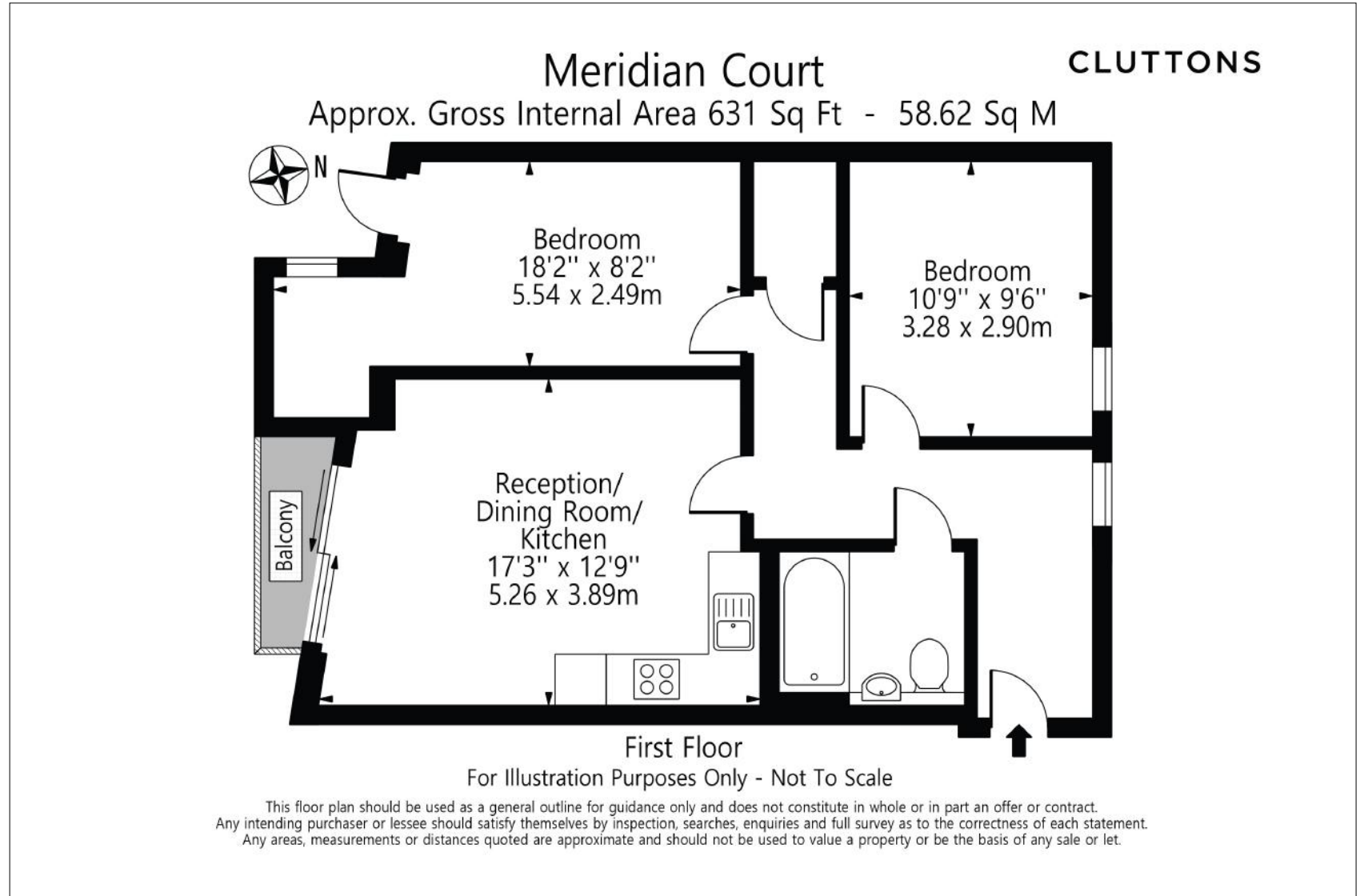

Approximate gross internal area:
631 sq ft (58.6 sq m)
EPC rating: C | Ref: TOW230092



For further details contact

George Barker
020 7407 3669
george.barker@cluttons.com

Alex Chapalain
020 7407 3669
alex.chapalain@cluttons.com

Cluttons
36 Horselydown Lane
London
SE1 2LN
cluttons.com

This is made from FSC certified paper, part of our commitment to use more sustainable materials. FSC, protecting the world's forests for the future. Please recycle.



Cluttons LLP for itself and as agent for the vendor or lessor (as appropriate) gives notice that: 1. These particulars are only a general outline for the guidance of intending purchasers or lessees and do not constitute in whole or in part an offer or a Contract. 2. Reasonable endeavours have been made to ensure that the information given in these particulars is materially correct but any intending purchaser or lessee should satisfy themselves by inspection, searches, enquiries and survey as to the correctness of each statement. 3. All statements in these particulars are made without responsibility on the part of Cluttons LLP or the vendor or lessor. 4. No statement in these particulars is to be relied upon as a statement or representation of fact. 5. Neither Cluttons LLP nor anyone in its employment or acting on its behalf has authority to make any representation or warranty in relation to this property. 6. Nothing in these particulars shall be deemed to be a statement that the property is in good repair or condition or otherwise nor that any services or facilities are in good working order. 7. Photographs may show only certain parts and aspects of the property at the time when the photographs were taken and you should rely upon actual inspection. 8. No assumption should be made in respects of parts of the property not shown in photographs. 9. Any areas, measurements or distances are only approximate. 10. Any reference to alterations or use is not intended to be a statement that any necessary planning, building regulation, listed building or any other consent has been obtained. 11. Amounts quoted are exclusive of VAT if applicable.