

**Tower Bridge Wharf E1W**  
£850,000 share of freehold

**CLUTTONS**



A second floor river view apartment, measuring 923 sq. ft, with a balcony and situated within one of West Wapping's highly regarded riverside developments, Tower Bridge Wharf.

Accommodation comprises: a spacious south-facing reception room with full-width private balcony boasting views of the River Thames, a kitchen with separated utility area, two well-sized double bedrooms both with built in wardrobes, one en suite shower room and a further family bathroom.

Residents benefit from secure allocated parking and 24 hour concierge.

Tower Bridge Wharf is well located along the River Thames, just a stone's throw from St Katharine Docks which offers a wide variety of cafes and restaurants. Tower Hill, Tower Gateway and Wapping stations are all within easy reach, providing regular transport links across London.

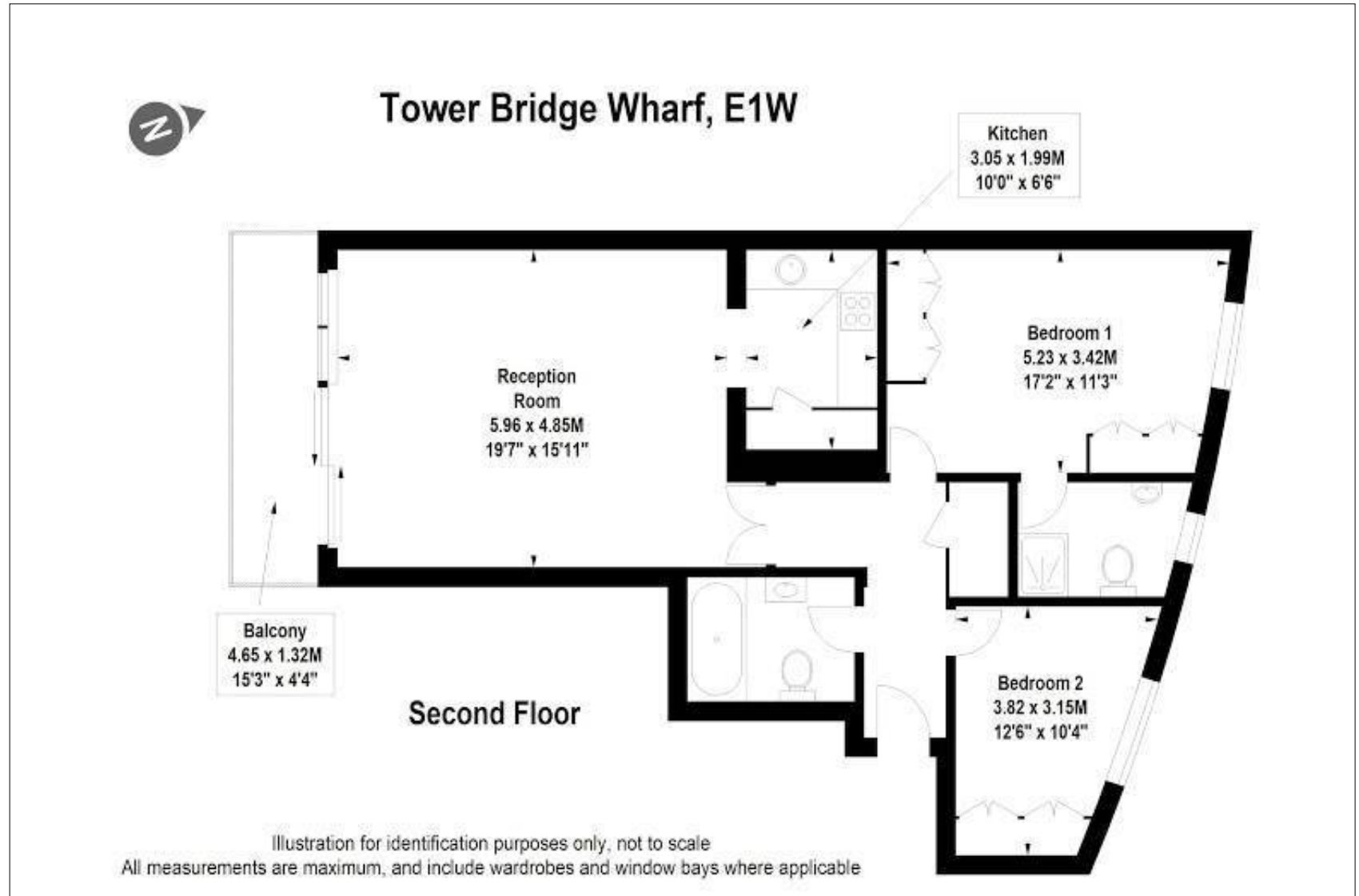

Approximate gross internal area:  
923 sq ft (85.7 sq m)  
EPC rating: C | Ref: WAP220072



For further details contact

Laura Banks  
020 7488 4858  
laura.banks@cluttons.com

This is made from FSC certified paper, part of our commitment to use more sustainable materials. FSC, protecting the world's forests for the future. Please recycle.



**Cluttons**  
3 Wapping High Street  
London  
E1W 1LS  
[cluttons.com](http://cluttons.com)

Cluttons LLP for itself and as agent for the vendor or lessor (as appropriate) gives notice that: 1. These particulars are only a general outline for the guidance of intending purchasers or lessees and do not constitute in whole or in part an offer or a Contract. 2. Reasonable endeavours have been made to ensure that the information given in these particulars is materially correct but any intending purchaser or lessee should satisfy themselves by inspection, searches, enquiries and survey as to the correctness of each statement. 3. All statements in these particulars are made without responsibility on the part of Cluttons LLP or the vendor or lessor. 4. No statement in these particulars is to be relied upon as a statement or representation of fact. 5. Neither Cluttons LLP nor anyone in its employment or acting on its behalf has authority to make any representation or warranty in relation to this property. 6. Nothing in these particulars shall be deemed to be a statement that the property is in good repair or condition or otherwise nor that any services or facilities are in good working order. 7. Photographs may show only certain parts and aspects of the property at the time when the photographs were taken and you should rely upon actual inspection. 8. No assumption should be made in respects of parts of the property not shown in photographs. 9. Any areas, measurements or distances are only approximate. 10. Any reference to alterations or use is not intended to be a statement that any necessary planning, building regulation, listed building or any other consent has been obtained. 11. Amounts quoted are exclusive of VAT if applicable.