

Java House E14

£600,000 leasehold

CLUTTONS



A well-presented first floor apartment with a generous wrap around terrace in the popular Ballymore development, London City Island.

The internal accommodation extends to 840 square feet and comprises a spacious reception room with floor to ceiling windows and an open plan kitchen with integrated appliances, two double bedrooms, one en suite shower room and a further family bathroom. A vast wrap around terrace can be accessed via the reception room and offers 667 square feet of external space.

Java House benefits from the use of extensive residents facilities at London City Island including 24 hour concierge, a fully equipped gymnasium, outdoor swimming pool, spa with sauna and steam rooms and a bespoke clubhouse.

Transport links are in abundance here at London City Island. For the frequent flyers, City Airport can be found just 7 minutes away via the DLR or approximately 10-15 minutes by car.

Canning Town station is within close proximity and is serviced by the DLR and Jubilee Line, allowing easy access to The City and Canary Wharf as well as the West End with just a 20 minute journey to Bond Street station.

Leasehold - 999 years from January 2014.
Ground rent £750 per annum
Service charge approximately £6,315.14 per annum. Council tax band E.

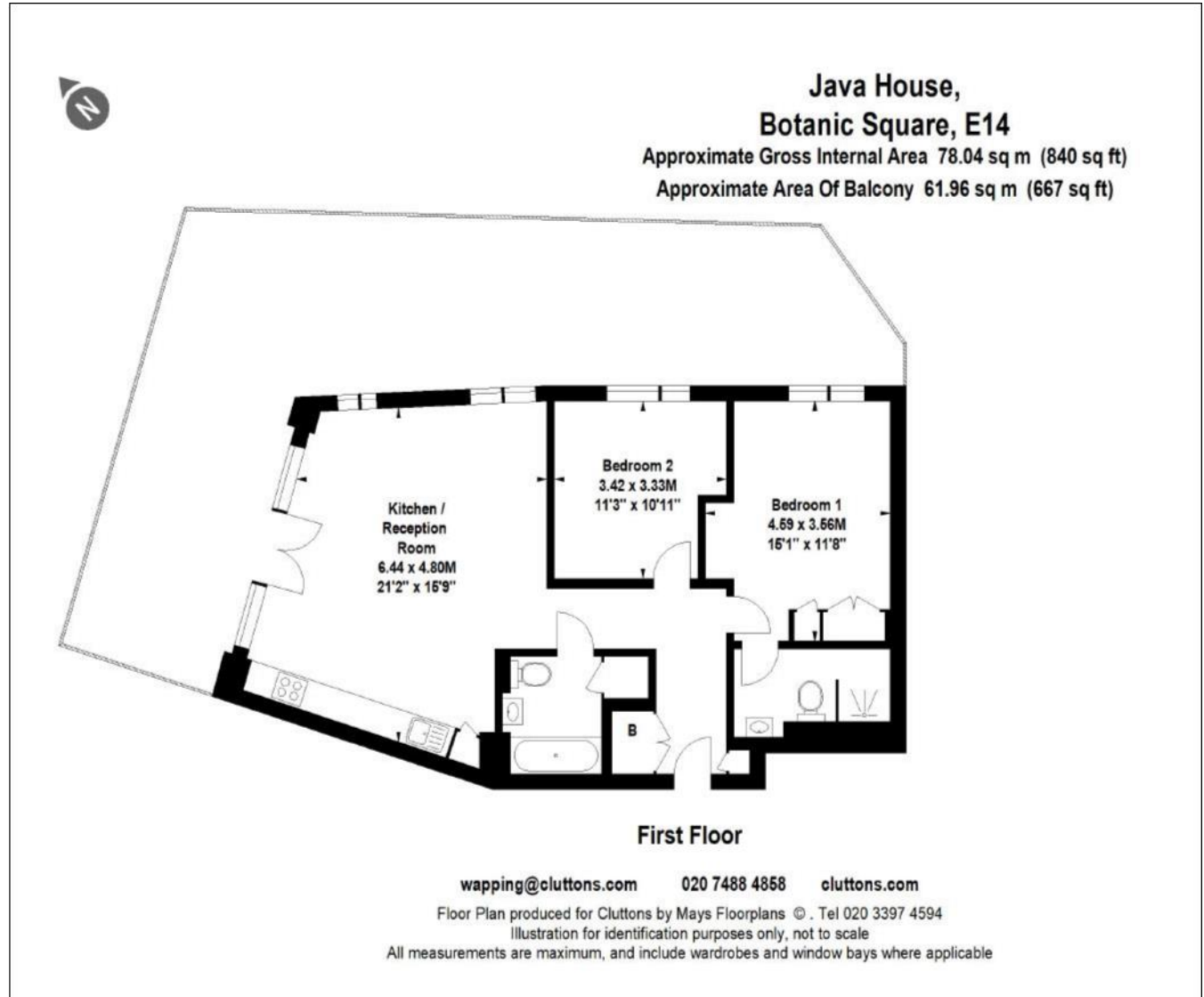

Approximate gross internal area:
840 sq ft (78 sq m)
EPC rating: B | Ref: WAP230039



For further details contact

Laura Banks
020 7488 4858
laura.banks@cluttons.com

Abby Perry
020 7488 4858
abby.perry@cluttons.com

Cluttons
3 Wapping High Street
London
E1W 1LS
cluttons.com

This is made from FSC certified paper, part of our commitment to use more sustainable materials. FSC, protecting the world's forests for the future. Please recycle.



Cluttons LLP for itself and as agent for the vendor or lessor (as appropriate) gives notice that: 1. These particulars are only a general outline for the guidance of intending purchasers or lessees and do not constitute in whole or in part an offer or a Contract. 2. Reasonable endeavours have been made to ensure that the information given in these particulars is materially correct but any intending purchaser or lessee should satisfy themselves by inspection, searches, enquiries and survey as to the correctness of each statement. 3. All statements in these particulars are made without responsibility on the part of Cluttons LLP or the vendor or lessor. 4. No statement in these particulars is to be relied upon as a statement or representation of fact. 5. Neither Cluttons LLP nor anyone in its employment or acting on its behalf has authority to make any representation or warranty in relation to this property. 6. Nothing in these particulars shall be deemed to be a statement that the property is in good repair or condition or otherwise nor that any services or facilities are in good working order. 7. Photographs may show only certain parts and aspects of the property at the time when the photographs were taken and you should rely upon actual inspection. 8. No assumption should be made in respects of parts of the property not shown in photographs. 9. Any areas, measurements or distances are only approximate. 10. Any reference to alterations or use is not intended to be a statement that any necessary planning, building regulation, listed building or any other consent has been obtained. 11. Amounts quoted are exclusive of VAT if applicable.