



## Linea Apartments, Scunthorpe North Lincolnshire DN15 6JL

- First Floor Apartment
- Kitchen / Living Room Area
- One Bedroom
- Bathroom
- EPC Rating: C



**Asking Price £65,000**

**Further information and viewings: Scunthorpe Office - 01724 868168**

□ 12a George Street  
Barton DN18 5ES  
Tel: 01652 661166  
e: barton@

□ 72 Wrawby Street  
Brigg DN20 8JE  
Tel: 01652 653666  
e: brigg@

□ 9 Church Street  
Gainsborough DN21 2JJ  
Tel: 01427 616161  
e: gainsborough@

□ 25 Osborne Street  
Grimsby DN31 1EY  
Tel: 01472 358671  
e: grimsby@

□ 46 Oswald Road  
Scunthorpe DN15 7PQ  
Tel: 01724 868168  
e: scunthorpe@

□ Fine & Country  
Barton & Brigg 237 666  
Grimsby 867 880  
Scunthorpe 304 999

the proactive agent

[ddmresidential.co.uk](http://ddmresidential.co.uk) e-mail: [info@ddmresidential.co.uk](mailto:info@ddmresidential.co.uk)



## **DESCRIPTION**

The first floor apartment has one double bedroom and a bathroom. Having electric fired central heating and double glazing throughout the property commands early and internal inspection. Walking distance of the town centre.

## **ACCOMMODATION**

### **ENTRANCE**

Through door into:

### **ENTRANCE HALLWAY**

With fitted carpet, storage heater, doors to all rooms and storage cupboard.

### **KITCHEN / LIVING ROOM AREA**

11'1" (3.38) x 12'11" (3.94) x 13' (3.96)

With fitted carpet, two windows to the rear aspect, fitted wall and base units, electric oven with electric hob and overhead extractor, stainless steel sink with mixer tap, integral fridge and freezer.

### **BEDROOM ONE**

9' x 9'9" (2.74m x 2.97m)

With fitted carpet, storage heater and window to the front aspect.

### **BATHROOM**

6'6" x 8'11" (1.98m x 2.72m)

With fully tiled walls, tiled flooring, hand wash basin, heated towel rail, low level w.c, enclosed bath with overhead shower and extractor.

### **STORAGE CUPBOARD**

Housing integral washer/dryer.

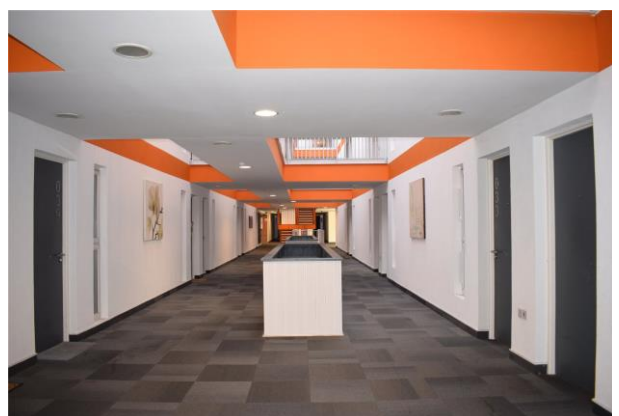

e: [info@ddmresidential.co.uk](mailto:info@ddmresidential.co.uk) :: [ddmresidential.co.uk](http://ddmresidential.co.uk)



The Largest Independent Auction, Estate & Letting Agency in the Region  
SALES ■ LETTINGS ■ MORTGAGE ADVICE ■ AUCTIONS ■ COMMERCIAL



Ask About Auction....  
over 130 auction  
properties sold last year



**REF: GRS20026 I**

e: [info@ddmresidential.co.uk](mailto:info@ddmresidential.co.uk) :: [ddmresidential.co.uk](http://ddmresidential.co.uk)



The Largest Independent Auction, Estate & Letting Agency in the Region  
SALES ■ LETTINGS ■ MORTGAGE ADVICE ■ AUCTIONS ■ COMMERCIAL



Ask About Auction....  
over 130 auction  
properties sold last year





# LANDLORDS GUIDE TO LETTING

**NOW AVAILABLE**



for a free lettings market appraisal from the proactive agent or to discuss changing agent call your local office or email [2017@ddmresidential.co.uk](mailto:2017@ddmresidential.co.uk)

download your free guide  
[ddmresidential.co.uk](http://ddmresidential.co.uk)



**NORTHERN LINCOLNSHIRE  
PROPERTY AUCTION**

we are the largest auction house  
in the region for a reason

110

average number of properties sold every year

for a catalogue, market appraisal or discuss changing to the Proactive Agent, contact your local office

Five Property Events  
held every year at  
Forest Pines Hotel, Brigg

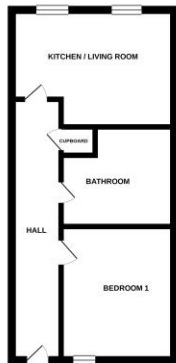

**Council Tax:** To confirm council tax banding for this property please contact the local authority or view the website [www.voa.gov.uk/cti](http://www.voa.gov.uk/cti)

**Tenure:** Freehold, Leasehold or Commonhold. It is important that prospective purchasers seek confirmation from their solicitors regarding the tenure.

**IMPORTANT Offer Procedure:** Before contacting a Mortgage Advisor you should make the offer to the branch dealing with the sale. Any delay may result in the sale being agreed to another purchaser. Under the Estate Agency Act 1991 you will be required to provide us with financial information in order to verify your position, before we can recommend your offer to the vendor. We will also require proof of identification in order to adhere to Money Laundering Regulations. DDM Financial can be contacted for no obligation mortgage advice on 01472 360094.

**IMPORTANT Note to Purchasers:** DDM Residential on their behalf and for the sellers of this property whose agents they are, give notice that 1/ these particulars are intended to be a general outline only for guidance of the prospective purchasers and do not constitute part of any contract 2/ all descriptions, dimensions, references to condition and necessary permissions for use and occupation and any other details are given in good faith and are believed to be correct and have been approved by the vendor, however intending purchasers should not rely upon them as statements or representations of fact, but must satisfy themselves by inspection or otherwise as to the correctness of each of them. 3/ no persons employed by DDM Residential has any authority to make or give any representation or warranty in relation to this property and no electrical or gas installations whether included or to be sold as additional items by the vendor have been tested by the vendor or their agents. 4/ nothing in these particulars, including photographs, is intended to imply that any carpets or curtains, furniture or fittings, electrical or gas appliances whether or not wired or plumbed in, or any other fixtures not expressly included as part of the property are offered for sale. Certain items may be purchased under separate negotiation.

□ 12a George Street  
**Barton DN18 5ES**  
Tel: 01652 661166  
e: barton@

□ 72 Wrawby Street  
**Brigg DN20 8JE**  
Tel: 01652 653666  
e: brigg@

□ 9 Church Street  
**Gainsborough DN21 2JJ**  
Tel: 01427 616161  
e: gainsborough@

□ 25 Osborne Street  
**Grimsby DN31 1EY**  
Tel: 01472 358671  
e: grimsby@

□ 46 Oswald Road  
**Scunthorpe DN15 7PQ**  
Tel: 01724 868168  
e: scunthorpe@

□ **Fine & Country**  
Barton & Brigg 237 666  
Grimsby 867 880  
Scunthorpe 304 999



the proactive agent

[ddmresidential.co.uk](http://ddmresidential.co.uk) e-mail: [info@ddmresidential.co.uk](mailto:info@ddmresidential.co.uk)

GW Time Limited Registered Office 46 Oswald Road Scunthorpe North Lincolnshire DN15 7PQ Registered in England No. 3844565