



HUDSONS

www.hudsonsproperty.com

RIDGMOUNT GARDENS, WC1E

£1,150,000



A very well presented and spacious (827sq ft) first floor 2 bedroom apartment set within a sought after red brick mansion block with concierge on the borders of Fitzrovia and Bloomsbury. Located moments from Goodge Street underground station, the restaurants in the Charlotte Street area and provides easy access to the West End, Regents Park and local world renowned Universities. The property boasts high ceilings, wood flooring and benefits from good natural daylight and comfortable living

- 2 Bedrooms
- Large reception
- High Ceilings
- Sought after red brick block
- Communal gardens
- Portorage



HUDSONS

www.hudsonsproperty.com

RIDGMOUNT GARDENS, WC1E

Ridgmount Gardens, WC1E 7AZ

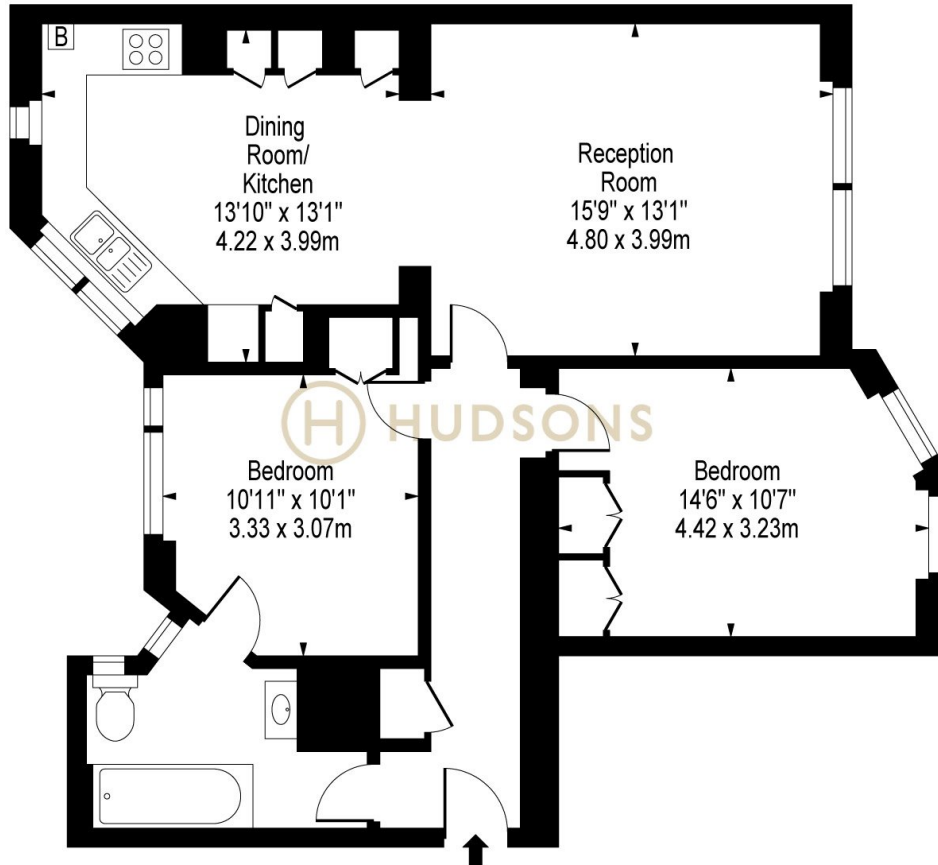
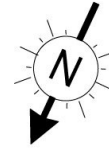

First Floor

Approx Gross Internal Area **827 Sq Ft - 76.83 Sq M**

For Illustration Purposes Only - Not To Scale
www.goldlens.co.uk
Ref. No. 003546M

All viewings by appointment through our **Charlotte Street office:**

T 020 7323 2277

E info@hudsonsproperty.com

24 Charlotte Street
London
W1T 2ND

hudsonsproperty.com

Hudsons Property give notice to anyone reading these particulars that: these particulars do not constitute part of an offer or contract; (ii) these particulars and any pictures or plans represent the opinion of the author and are given in good faith for guidance only and must not be construed as statements of fact; (iii) nothing in the particulars shall be deemed a statement that the property is in good condition otherwise; we have not carried out a structural survey of the property and have not tested the services, appliances or specified fittings.

Full Energy Performance Certificate available on request.

Energy Efficiency Rating		Current	Potential
Very energy efficient - lower running costs			
(92-)	A		
(81-91)	B		
(69-80)	C		81
(55-68)	D	62	
(39-54)	E		
(21-38)	F		
(1-20)	G		
Not energy efficient - higher running costs			
England, Scotland & Wales		EU Directive 2002/91/EC	