

Rutland Gate

KNIGHTSBRIDGE, SW7 1PD

Kaye & Carey



RUTLAND GATE

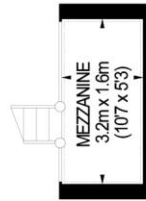

FIRST FLOOR

□ = REDUCED HEADROOM BELOW 1.5 M / 5'0

APPROXIMATE GROSS INTERNAL AREA
FIRST FLOOR = 627 SQ. FT. (58.2 SQ. M.)
MEZZANINE (INCLUDING REDUCED HEADROOM) = 62 SQ. FT. (5.7 SQ. M.)
TOTAL = 689 SQ. FT. (63.9 SQ. M.)

MEZZANINE



LETTING INVESTMENT

Currently let at **£950 per week until 13th July 2021**, an exceptional one bedroom flat, with a balcony, on the first floor of this substantial stucco-fronted period building facing West over one of Knightsbridge's premier garden squares.

Rutland Gate lies just to the south of Hyde Park and is only a short walk from all the facilities of Brompton Road including Harrods and Knightsbridge Tube station.



Bedroom with en-suite Shower Room
Guest WC
Reception Room with open plan Kitchen
Balcony

Leasehold: Expiring March 2157

Guide Price: £1,495,000 Subject to Contract

Energy Efficiency Rating		
	Current	Potential
Very energy efficient - lower running costs		
(92+) A		
(81-91) B		
(69-80) C	73	77
(55-68) D		
(39-54) E		
(21-38) F		
(1-20) G		
Not energy efficient - higher running costs		
England, Scotland & Wales	EU Directive 2002/91/EC	

Kaye & Carey, their clients and any joint agents give notice that:

a) They have no authority to make or give any representations or warranties in relation to the property. b) These sales particulars do not constitute an offer or contract. c) Any areas, measurements or distances are approximate. d) The text, photographs and plans are not necessarily comprehensive and are for guidance only. e) It should not be assumed that the property has all necessary planning, building regulations or other consents. f) Kaye & Carey have not tested any services or appliances. g) Prospective purchasers must satisfy themselves by inspection or otherwise to the correctness of the information given.

Kaye & Carey

020 7590 0066

4 Yeoman's Row, Brompton Road, London SW3 2AH

www.kayeandcarey.co.uk