

For Sale

Asking Price: €115,000

Sherry
FitzGerald
O'Neill



Cnoc Mhuire, Toughbawn,
Drinagh, Co Cork, P47 RX74

BER D1

sherryfitz.ie



Attractive 3 bedroom semi-detached house and garage, situated in a pleasant sunny location, within Drinagh Village.

The many features of the property include a sunny south-facing garden area to the front and side, gas-fired central heating, double glazed windows, open fireplace in the living room & dining room.

The house extends to 832 sq.ft approximately and comprises entrance hallway, living room, dining room and kitchen on ground floor. The upstairs contains 3 bedrooms and a bathroom.

There is also potential to extend the property and the convenient village location ensures that the property has the potential to be a fine home or investment property.



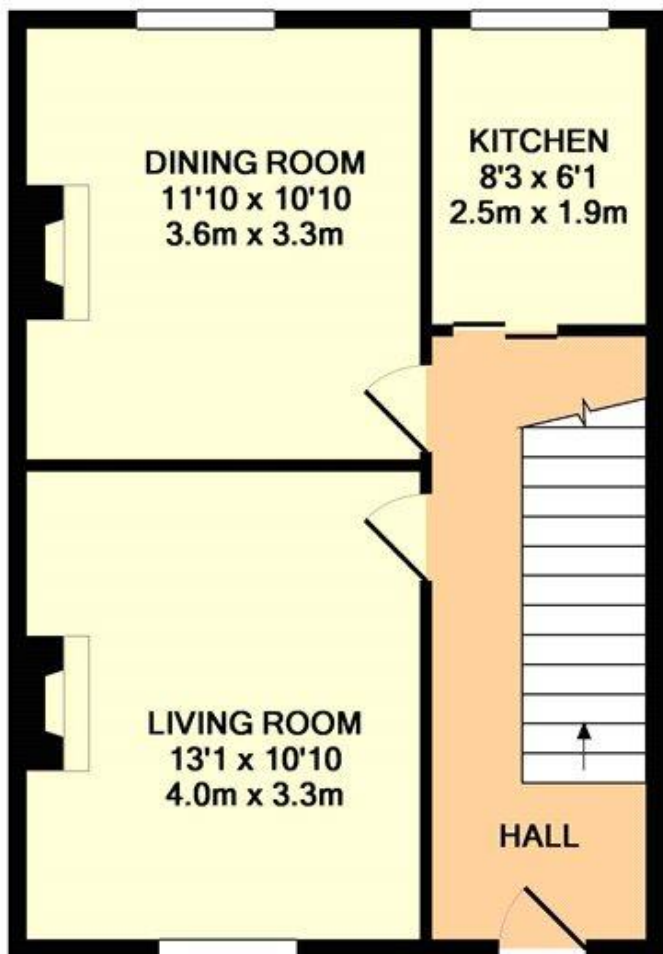

GROUND FLOOR
APPROX. FLOOR
AREA 416 SQ.FT.
(38.6 SQ.M.)

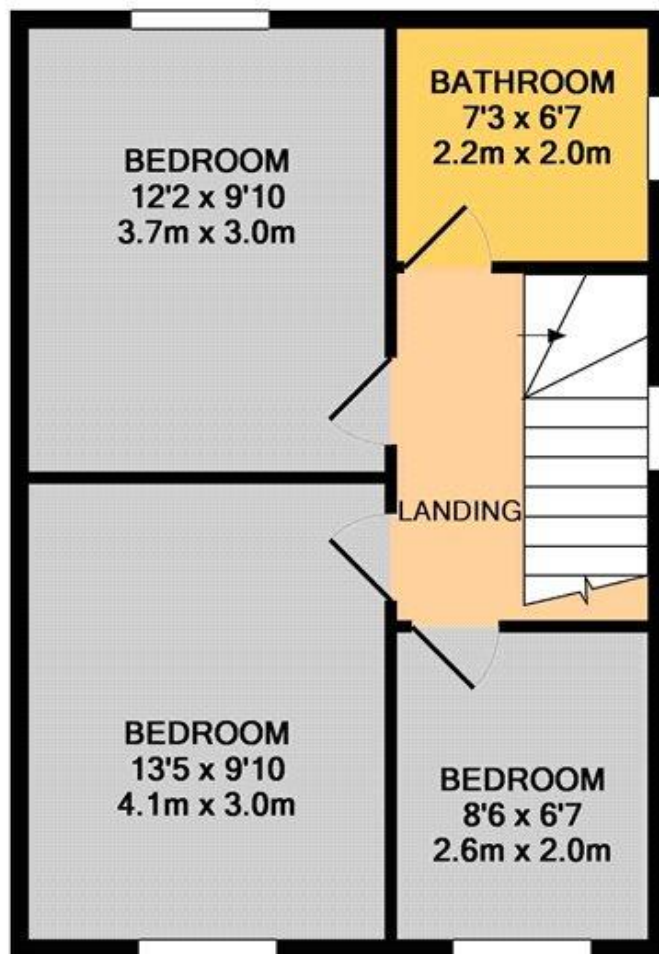

1ST FLOOR
APPROX. FLOOR
AREA 416 SQ.FT.
(38.6 SQ.M.)

TOTAL APPROX. FLOOR AREA 832 SQ.FT. (77.3 SQ.M.)

Whilst every attempt has been made to ensure the accuracy of the floor plan contained here, measurements of doors, windows, rooms and any other items are approximate and no responsibility is taken for any error, omission, or mis-statement. This plan is for illustrative purposes only and should be used as such by any prospective purchaser. The services, systems and appliances shown have not been tested and no guarantee as to their operability or efficiency can be given

Made with Metropix ©2019



NEGOTIATOR

Olivia Hanafin
Sherry FitzGerald O'Neill
37 North Street, Skibbereen,
Co Cork
T: 028 21404
E: info@sfoneill.ie

VIEWING:

Viewing by Appointment

ENERGY RATING

BER: D1
BER No.: 112427521
BER EPI: 239.64 kWh/m²/yr

sherryfitz.ie

sfoneill.ie

myhome.ie

daft.ie

rightmove.co.uk

CONDITIONS TO BE NOTED: A full copy of our general brochure conditions can be viewed on our website at <http://www.sherryfitz.ie/terms>, or can be requested from your local Sherry FitzGerald office. We strongly recommend that you familiarise yourself with these general conditions. While care has been taken to ensure that information contained in Sherry FitzGerald publications is correct at the time of publication, changes in circumstances after the time of publication may impact on the accuracy of this. PSRA Registration No. 001154