



**CRAWFORD PLACE, NEWBURY, RG14**

Asking Price: £288,000 | Leasehold

**SANSOME  
&GEORGE**

## CRAWFORD PLACE, NEWBURY, RG14

SANSOME & GEORGE NEWBURY OFFICE - Re-furbished 3 BEDROOM split level maisonette within walking distance of Newbury Town Centre. This deceptively spacious home benefits from a newly installed fitted kitchen, newly fitted bathroom, reception/dining room and 3 Bedrooms. Early viewings highly recommended in order to avoid disappointment. Crawford Place is ideally located within walking distance of Newbury town centre and Newbury railway station which provides a direct link to London Paddington. NO ONWARD CHAIN. Early viewing highly recommended in order to appreciate this charming home.

### Accommodation & Amenities

- 3 Bedroom Maisonette
- Newly installed fitted kitchen
- Newly installed fitted bathroom
- Reception/dining room
- 3 Bedrooms

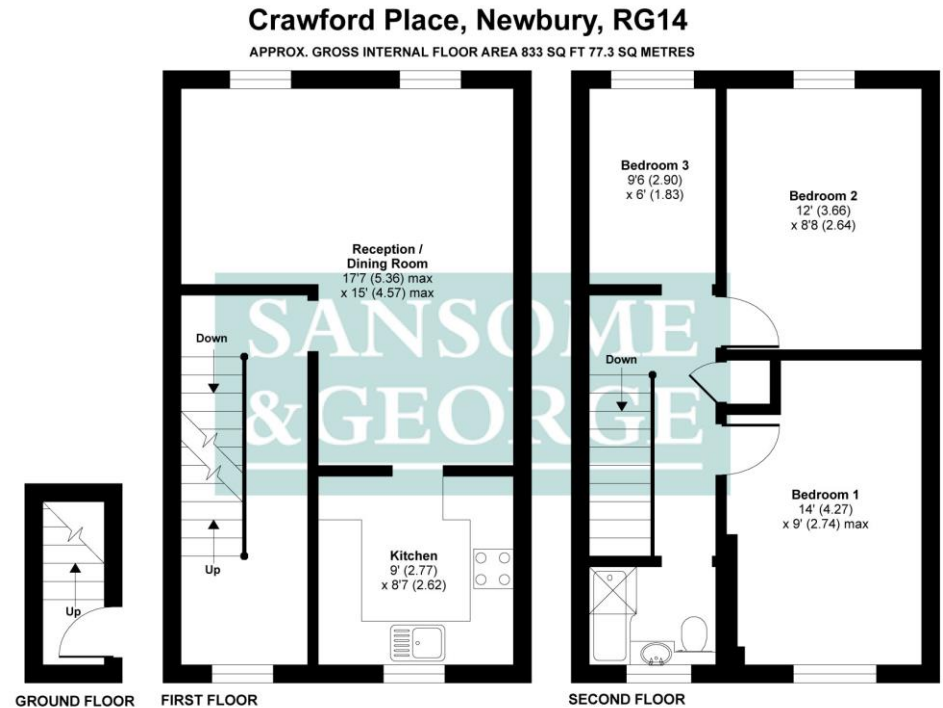

Whilst every attempt has been made to ensure the accuracy of the floor plan contained here, measurements of doors, windows and rooms are approximate and no responsibility is taken for any error, omission or misstatement. These plans are for representation purposes only as defined by RICS Code of Measuring Practice and should be used as such by any prospective purchaser. Specifically no guarantee is given on the total square footage of the property if quoted on this plan. Any figure given is for initial guidance only and should not be relied on as a basis of valuation.

Copyright nichecom.co.uk 2019    Produced for Sansome & George    REF : 450791

Approximate Gross Internal Area  
0 sq. ft / 0.0 sq. m





