

Pennybank Chambers, EC2A

£425,000

Share of Freehold



Pennybank Chambers, EC2A

£425,000

Share of Freehold

- Wooden Floors
- Entry Phone System
- One bedroom
- Excellent decorative order
- Furnished
- Open Plan Kitchen

Set on the top floor of this highly sought-after and attractive period mansion block on the edge of the City, is a well presented one bedroom apartment.

The property boasts sash windows throughout and comprises a bright reception, double bedroom, separate kitchen and a modern bathroom.

Situated in the heart of Shoreditch, just moments from a plethora of restaurants, bars and coffee shops, the property is within a short walk to the financial district. Old Street & Liverpool Street stations (Northern & National Rail) is just a stone's throw away whilst the major transport hub of Liverpool Street is also nearby.

The area is benefitting from major investment, attracting some of the world's biggest tech firms and hotels. Offered with no onward chain making this an ideal first purchase and/or investment.



For viewings contact
our Shoreditch Office

40 Great Eastern Street
EC2A 3EP

tel: 0203 911 3660

e:
ec2@stirlingackroyd.com



StirlingAckroyd.com

For viewings contact
our Shoreditch Office

40 Great Eastern Street
EC2A 3EP

tel: 0203 911 3660
e:
ec2@stirlingackroyd.com

| Energy Efficiency Rating | | Current | Potential |
|---|---|----------------------------|-----------|
| Very energy efficient - lower running costs | | | |
| (92+) | A | | |
| (81-91) | B | | |
| (69-80) | C | | |
| (55-68) | D | 59 | 72 |
| (39-54) | E | | |
| (21-38) | F | | |
| (1-20) | G | | |
| Not energy efficient - higher running costs | | | |
| England, Scotland & Wales | | EU Directive 2002/91/EC | |



StirlingAckroyd.com

Important Notice: Stirling Ackroyd (and their Joint Agents where applicable) for themselves and for purchasers or tenants, and do not constitute the whole or any part of an offer or contract; (ii) Stirling herein and prospective purchasers or tenants must not rely on them as statements of fact or represent any representation or warranty or enter into any contract whatever in relation to the property; (iv) refer use of these particulars.

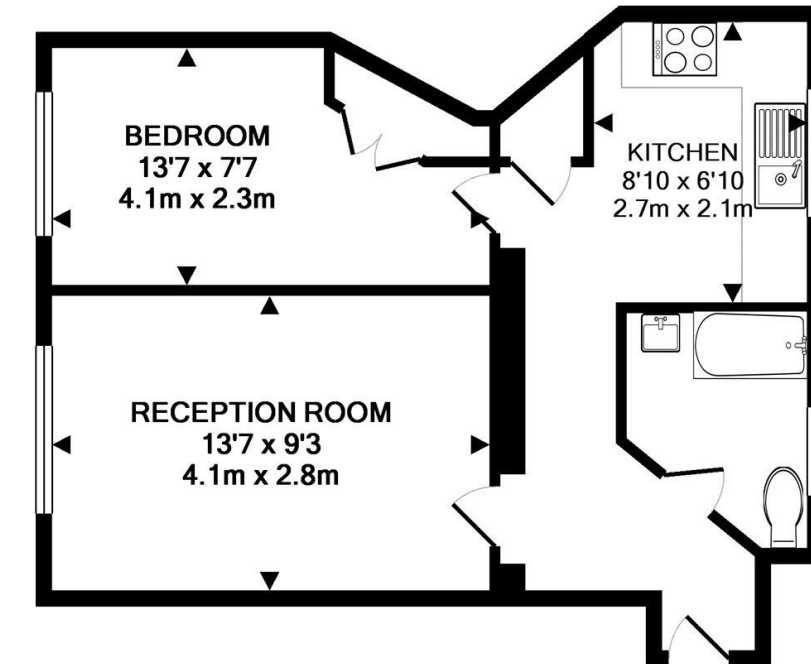

TOTAL APPROX. FLOOR AREA 385 SQ.FT. (35.7

Whilst every attempt has been made to ensure the accuracy of the floor plan of doors, windows, rooms and any other items are approximate and no responsibility, omission, or mis-statement. This plan is for illustrative purposes only and should not be relied upon by a prospective purchaser. The services, systems and appliances shown have not been inspected and no guarantee as to their operability or efficiency can be given
Made with Metropix ©2017

