



Harvard Road, Isleworth, TW7 4PA
£225,000





For Sale By Online Auction - Starting Bid £225,000 - Terms & Conditions Apply

A nicely presented, one-bedroom apartment with own front door entrance and patio, which is conveniently located just moments from Isleworth Rail Station and benefitting from secure residents parking. Odeon Parade is situated in the centre of historic Isleworth, within walking distance from

the River Thames, Syon and Osterley (National Trust) Parks.

The property comprises high ceilings, a large modern reception measuring an impressive 16'2 x 13'1, open-plan fitted kitchen and large double bedroom with fitted wardrobes and en-suite. This superb development is located on the doorstep of great transport links including Isleworth Mainline Station (serving London Waterloo) Osterley Tube

(Piccadilly Line to Central London and Heathrow) and several main bus routes.

The property is being sold with no onward chain and a long lease, perfect for investors or first-time buyers, viewings are highly recommended.



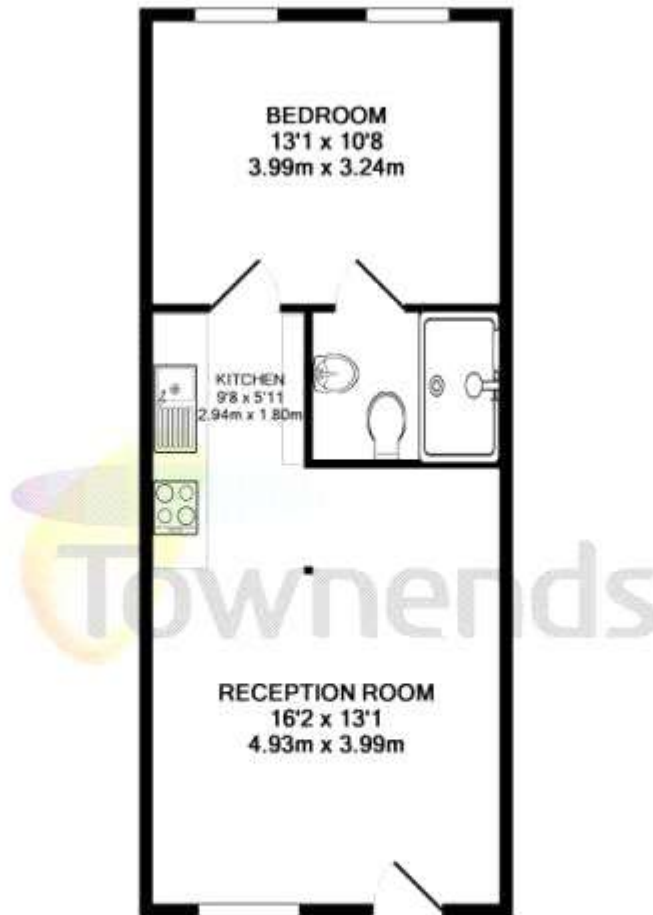

TOTAL APPROX. FLOOR AREA 425 SQ.FT. (39.5 SQ.M.)

Whilst every attempt has been made to ensure the accuracy of the floor plan contained here, measurements of doors, windows, rooms and any other items are approximate and no responsibility is taken for any error, omission, or mis-statement. This plan is for illustrative purposes only and should be used as such by any prospective purchaser. The services, systems and appliances shown have not been tested and no guarantee as to their operability or efficiency can be given.
Made with Metropix ©2014.



Viewing arrangement by appointment 02039111756

twickenham@townends.co.uk

25 London Road, Twickenham, Middlesex, TW1 3SX

townends.co.uk

TOWNENDS_BH021_CEN210068_DTL001_5

