



Sumner Street, London, SE1 9RE
Offers Over £800,000





Larger than average living space and luxury interiors are on offer with this one-bedroom apartment. Situated on the third floor, this well apportioned apartment offers over 880 square feet of living space.

Immaculately presented, this apartment features an open plan reception, high specification modern fitted kitchen, double bedroom with fitted wardrobes, a winter garden and a luxury bathroom. This is the perfect apartment for professionals working in The City or Canary Wharf due to its close proximity to both.

Neo Bankside is situated on Bankside and is a short walk from Southwark and London Bridge underground and National Rail Stations offering convenient access to the Jubilee and Northern Line as well as National Rail links from London Bridge Station. With its excellent transport links, this location makes the whole of London accessible in minutes.



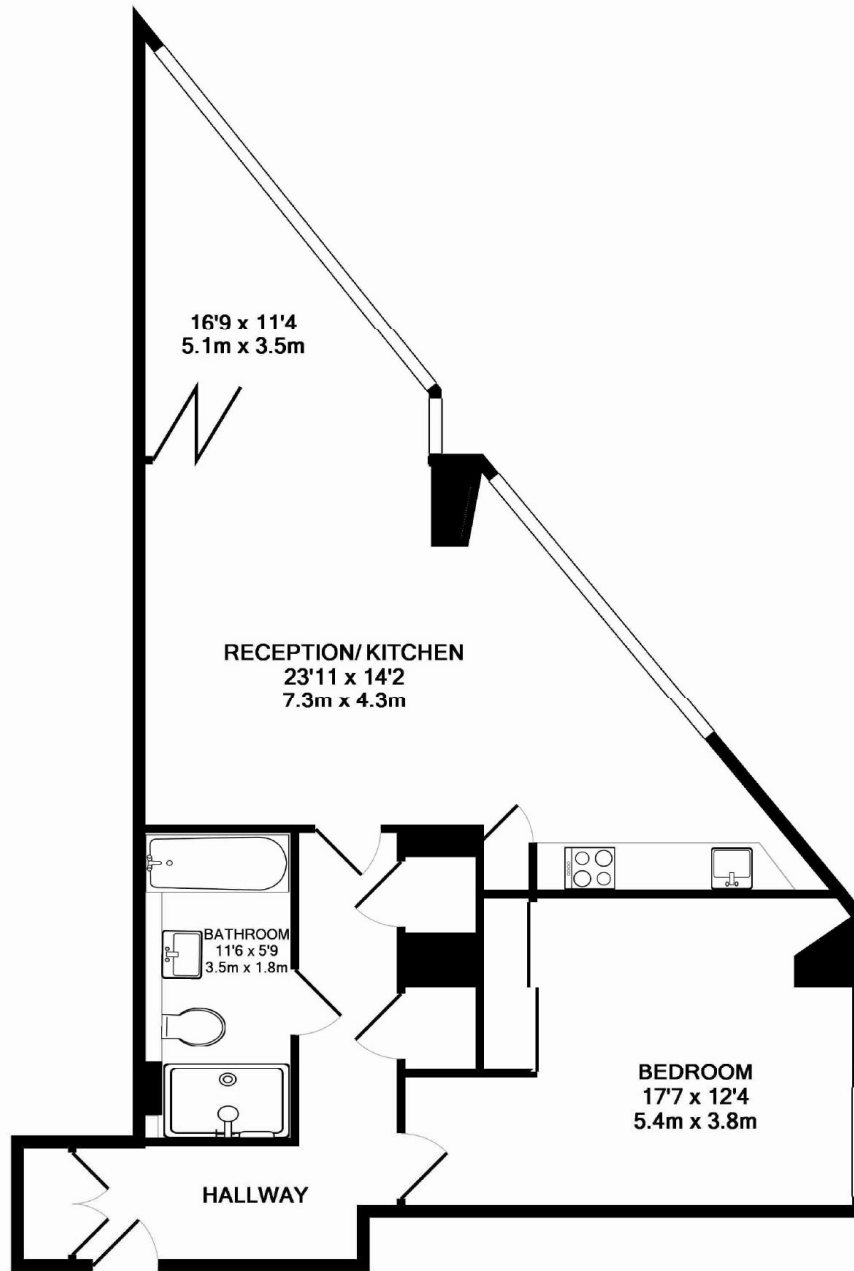

3RD FLOOR

NEO BANKSIDE SE1
TOTAL APPROX. FLOOR AREA 883 SQ.FT. (82.0 SQ.M.)
Measurements are approximate. Not to scale. Illustrative purposes only



Viewing arrangement by appointment 0203 911 3661

se1@stirlingackroyd.com

56 Borough High Street, London, SE1 1XF

stirlingackroyd.com

STIRLING ACKROYD_STI015_CEN210165_DTL001_5

