



## Justin Close, Brentford, TW8 8QA

2 Beds | 1 Bath | 1 Reception Room | Guide Price £350,000 |

EPC **D**



## Justin Close, Brentford, TW8 8QA

2 Beds | 1 Bath | 1 Reception Room |  
Guide Price £350,000

---

For Sale via Pattinsons - Terms & Conditions Apply

Starting bid - £350,000

Fantastic two double bedroom apartment in the ever-popular Brentford Dock. The property comprises an open-plan lounge/dining room with large private balcony, two double bedrooms with fitted wardrobes, fitted kitchen and bathroom. There are some beautiful walks along River Thames and through Syon Park and there are extensive on-site communal gardens.



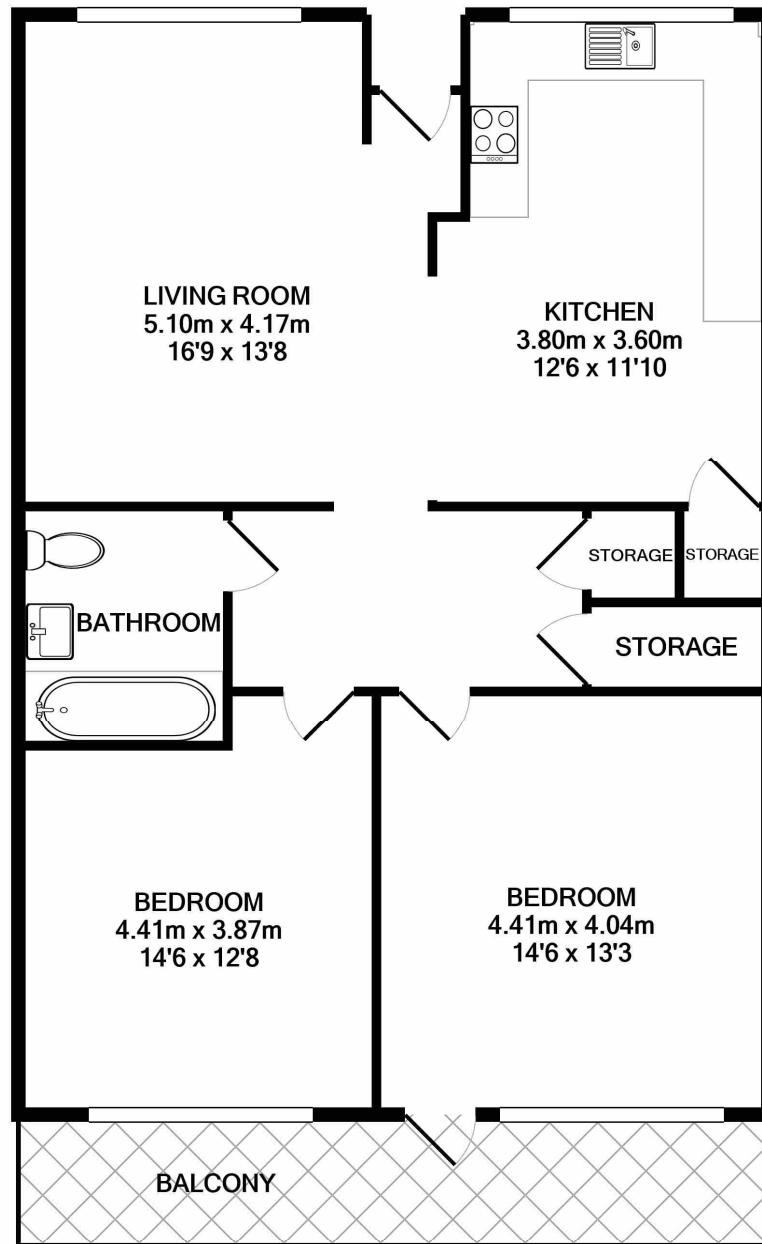

TOTAL APPROX. FLOOR AREA 88.7 SQ.M. (955 SQ.FT.)

Whilst every attempt has been made to ensure the accuracy of the floor plan contained here, measurements of doors, windows, rooms and any other items are approximate and no responsibility is taken for any error, omission, or mis-statement. This plan is for illustrative purposes only and should be used as such by any prospective purchaser. The services, systems and appliances shown have not been tested and no guarantee as to their operability or efficiency can be given





**Viewing arrangement by appointment**

**02039111636**

**[chiswick@stirlingackroyd.com](mailto:chiswick@stirlingackroyd.com)**

**440 Chiswick High Road, Chiswick, London, W4 5TT**

**[stirlingackroyd.com](http://stirlingackroyd.com)**

