



Erskine House, Churchill Gardens, SW1V 3DR  
OIEO £425,000





Set within the ever-popular Churchill Gardens estate and therefore affording superb amenities merely a stone's throw away, this wonderfully presented first-floor one-bedroom apartment offers over 450 square feet of living space.

Awash with natural light throughout, the property plays host to one double bedroom, open-plan living/kitchen room and separate family bathroom.

Just half a mile from Pimlico Station offering easy access to the city centre via the Victoria line, you'll find the River Thames merely a minute's walk away.

Ideally suited to first time buyers and investors alike, an early internal inspection is highly recommended.

- 1 Bedroom
- Flat/Apartment
- Leasehold



**Approximate Gross Internal Area**  
**457 sq ft - 42 sq m**

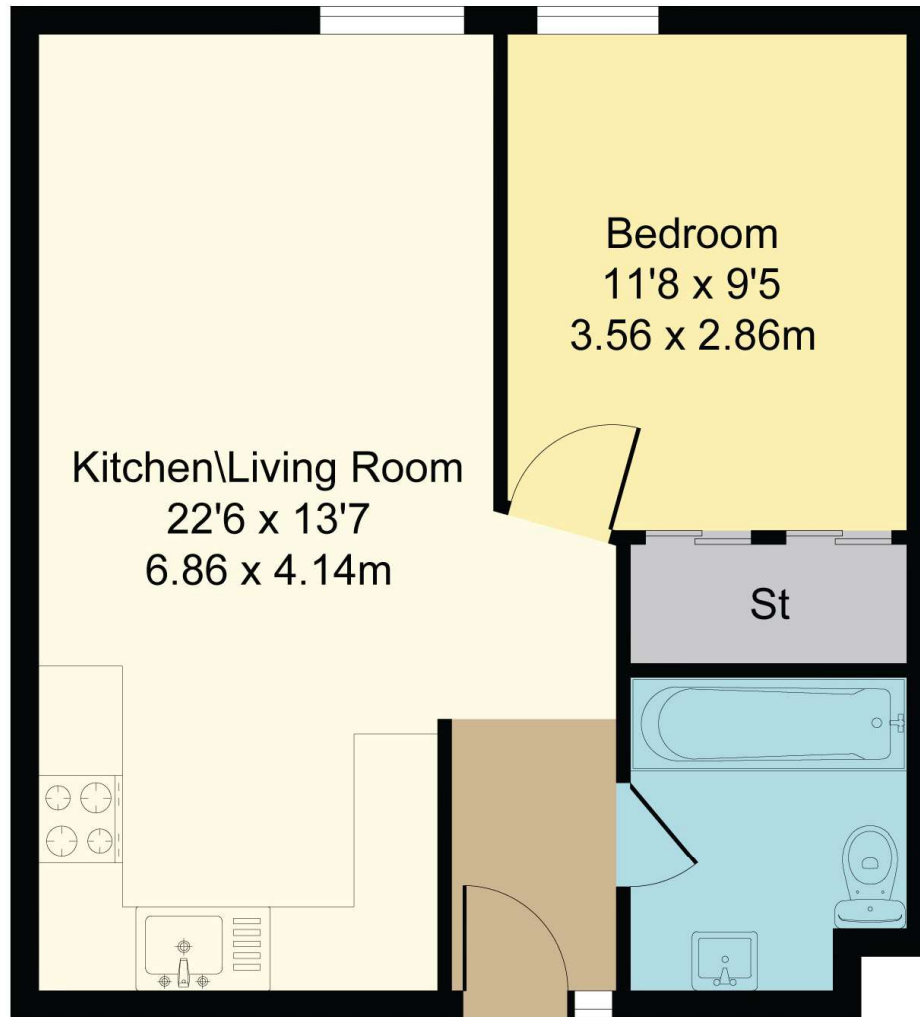





Viewing arrangement by appointment

[nineelmssales@stirlingackroyd.com](mailto:nineelmssales@stirlingackroyd.com)

2.08 Tintagel House, 92 Albert Embankment, London, SE1 7TY

STIRLING ACKROYD\_\_CSC200332\_DTL001\_5

