



**Epsom Road
Guildford, GU1
£3,500 per month**



ZERO DEPOSIT OPTION AVAILABLE

A luxury town centre penthouse apartment in one of Guildford's most prestigious developments. With concierge service, fitness suite, indoor pool, jacuzzi and sauna the facilities included on site are un-rivalled for Guildford Town Centre. Accessed via a lift the penthouse apartment is located on the 4th floor where you can enjoy some fantastic views of the High Street, The Surrey Downs and Guildford Cathedral. With a 40ft roof terrace on either side of the apartment and large floor to ceiling, double sliding doors in every room light simply floods into the property at all times of day. There is even the benefit of a sky light in the entrance hall to brighten things up. At night the views are equally impressive and both terraces are great for entertaining with space for a BBQ, table and chairs or simply for relaxing on sun loungers. There are three double bedrooms (all with fitted cupboards) three bath/ shower rooms (two en-suite), 40' open plan living/dining, luxury fully fitted and integrated kitchen (with granite work surfaces) and high specification fixtures and fittings throughout.

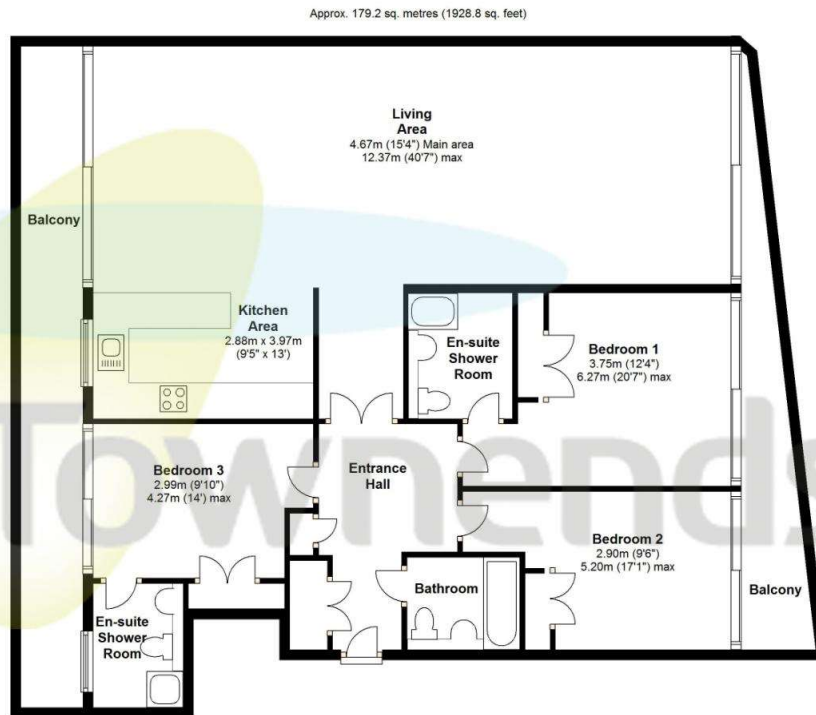

Total area: approx. 179.2 sq. metres (1928.8 sq. feet)

Whilst every attempt has been made to ensure the accuracy of the floor plan shown here, measurements of doors, windows, rooms and any other items are approximate and no responsibility is taken for any error, omission, or mis-statement. This plan is for illustrative purposes only and should be used as such by any prospective purchaser. The services, systems and appliances shown have not been tested and no guarantee as to their operability or efficiency can be given. Virtual Vue Ltd

Viewing arrangement by appointment 01483668066

guildfordlettings@townends.co.uk

3 Epsom Road, Guildford, Surrey, GU1 3JT

townends.co.uk