



Crown Point, Beulah Hill, SE19 3NF  
£285,000





For Sale via Pattinsons - Terms & Conditions Apply

First floor flat comprising large lounge with stripped wooden floors and bay window, modern galley kitchen with appliances, three double bedrooms with carpets and modern bathroom with electric shower.

The apartment is surrounded by all the amenities and transport links Streatham has to offer and is just a 15-minute walk to West Norwood Station.

Situated close to Streatham Common and the Rookery Gardens as well as Norwood Park and Upper Norwood Recreation Ground, the apartment is well positioned for plenty of outside space.

- 3 Bedrooms
- Flat/Apartment
- Leasehold
- Close to Transport and Amenities



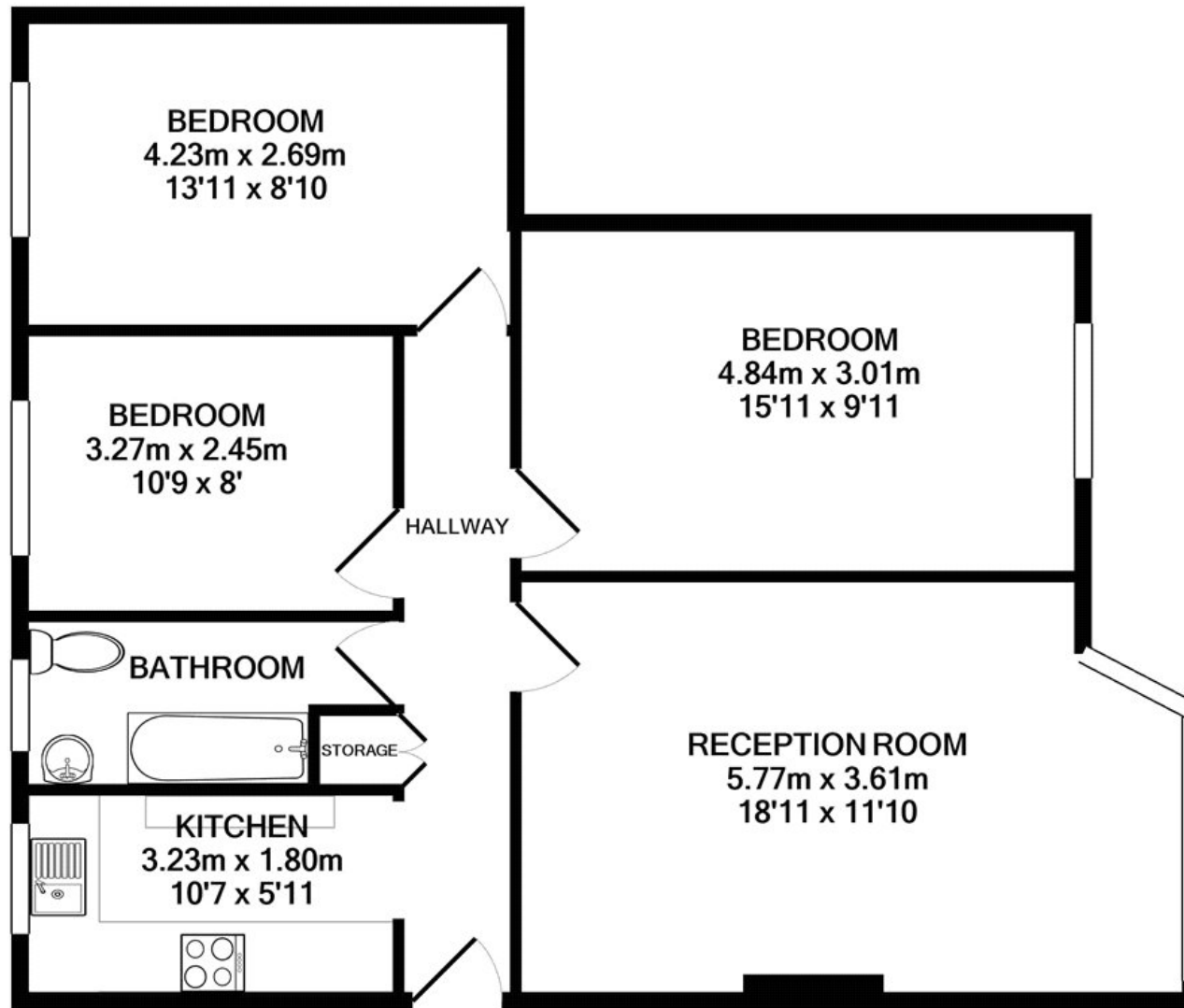

**TOTAL APPROX. FLOOR AREA 69.9 SQ.M. (753 SQ.FT.)**

Whilst every attempt has been made to ensure the accuracy of the floor plan contained here, measurements of doors, windows, rooms and any other items are approximate and no responsibility is taken for any error, omission, or mis-statement. This plan is for illustrative purposes only and should be used as such by any prospective purchaser. The services, systems and appliances shown have not been tested and no guarantee as to their operability or efficiency can be given

Made with Metropix ©2021



Viewing arrangement by appointment 02039111736

[streatham@townends.co.uk](mailto:streatham@townends.co.uk)

5-7 Streatleigh Parade, Streatham High Road, Streatham, London, SW16 1EQ

[townends.co.uk](http://townends.co.uk)

TOWNENDS\_BH018\_NOL050066\_DTL001\_5

