



Oakhill Road, Putney, SW15 2QU  
**£675,000**





This is a spacious three double bedroom second floor lateral apartment situated in a superb road within a short walk of East Putney Tube Station. The property offers a good sized living room with an open-plan modern kitchen inclusive of built-in appliances, modern shower room, three bedrooms and an allocated parking space. Oakhill Road is a short distance away from the shops, restaurants and transport facilities of Putney High Street. Both Putney Mainline Station, with direct access into Waterloo, and East Putney Underground Station (District Line) are within walking distance. The A3 is approached via West Hill and Wandsworth Park with its open spaces and river walk is only a short distance away.



- 3 Bedrooms
- Flat/Apartment
- Leasehold

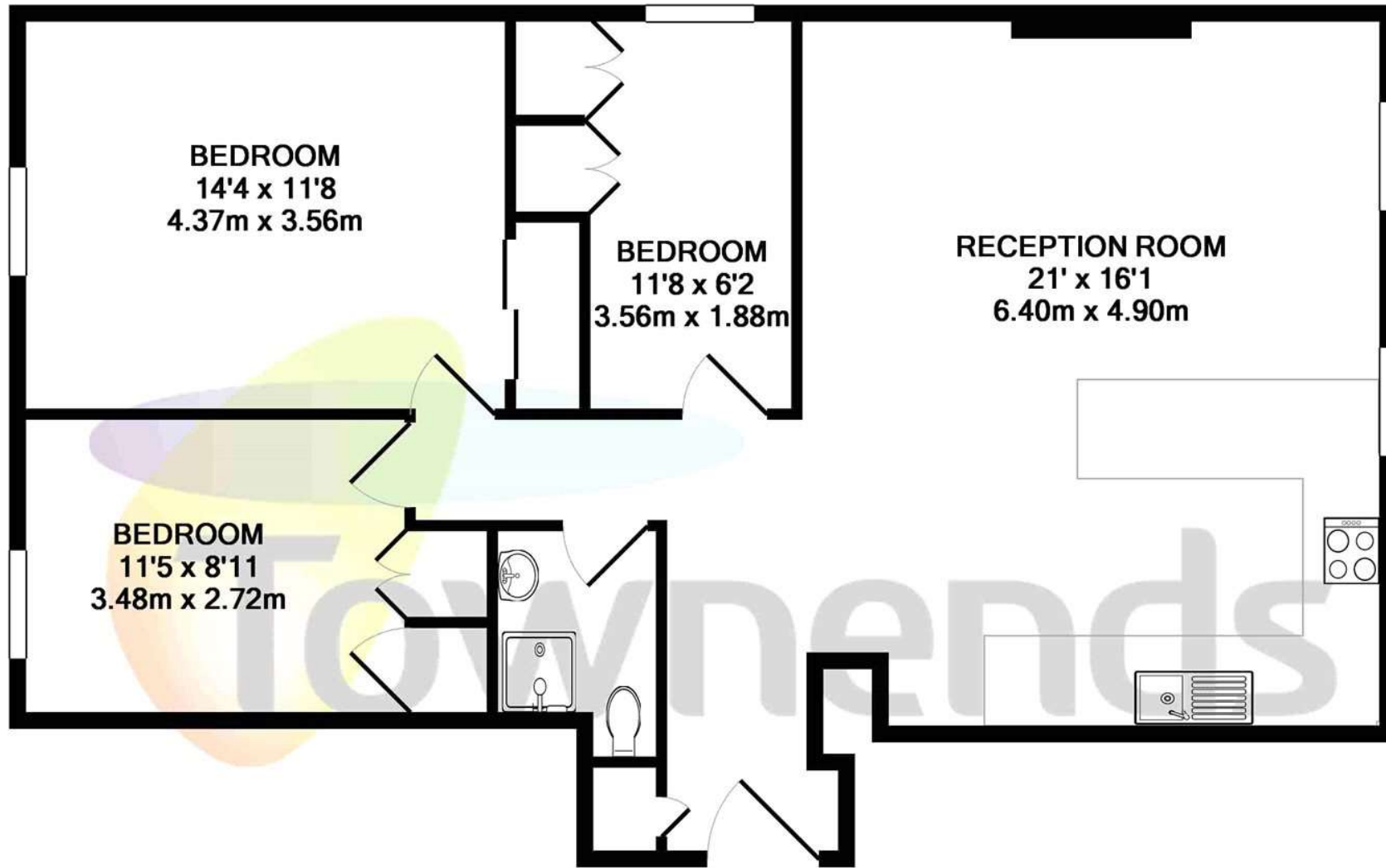

TOTAL APPROX. FLOOR AREA 850 SQ.FT. (78.9 SQ.M.)

Whilst every attempt has been made to ensure the accuracy of the floor plan contained here, measurements of doors, windows, rooms and any other items are approximate and no responsibility is taken for any error, omission, or mis-statement. This plan is for illustrative purposes only and should be used as such by any prospective purchaser. The services, systems and appliances shown have not been tested and no guarantee as to their operability or efficiency can be given

Made with Metropix ©2018



Viewing arrangement by appointment 02039111696

[putney@townends.co.uk](mailto:putney@townends.co.uk)

167 High Street, Putney, London, SW15 1RT

[townends.co.uk](http://townends.co.uk)

TOWNENDS\_BH014\_PUT170137\_DTL001\_5

