



Osborne Road, Egham, TW20 9RN
£280,000





HELP TO BUY AVAILABLE!

Offered to the market is this impressive period conversion apartment. The whole block has been fully renovated and finished to an exceptional standard!

The flat is found only a short walk from Egham Mainline Station with only a 40-minute journey to London Waterloo and are within easy reach of M25, M3 and A30.

Further to this Heathrow Airport is only a short distance. The property itself hosts integrated appliances, gas central heating and doors which lead out to a private enclosed garden.

Viewings on this are highly recommended to appreciate the finish!

- 1 Bedroom
- Flat/Apartment
- Leasehold
- Fully renovated



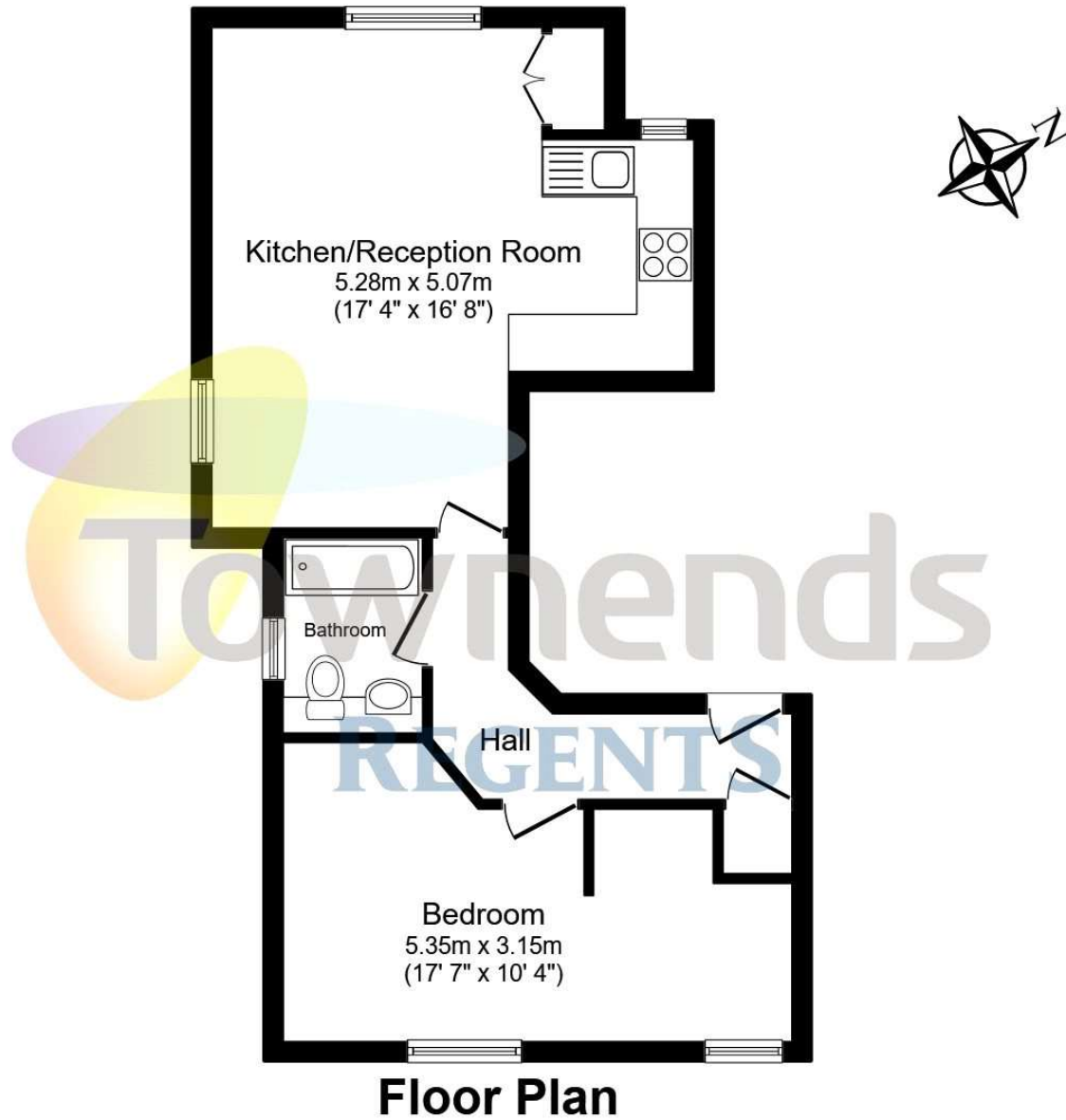

Floor Plan

Total floor area 46.0 sq. m. (495 sq. ft.) approx

This plan is for illustration purposes only and may not be representative of the property.
Plan not to scale.



Viewing arrangement by appointment 01784779506

egham@townends.co.uk

179 High Street, Egham, Surrey, TW20 9EJ

[townends.co.uk](https://www.townends.co.uk)

TOWNENDS REGENTS_TR003_SUT180265_DTL001_5

